

- Key
- Site Bound
 - Visibility splay 2.4m x 215m
 - Wheelbase track
 - Vehicle body

Notes:

Proposed bellmouth access to tie into track measuring 5.5m.

Due to vertical profile of the B764 (brow of hill at Kingswell), it is recommend that the proposed bellmouth is not moved further north from the location shown, as this may impact upon the vertical visibility envelope which should be measured to an object height of between 0.26m and 2.00m as identified in DMRB 9/93.

Topographical survey will confirm levels of carrieway and verge.

Vehicle Profile - 17.5 steel Beam, 4 Axle Doll Arrangement

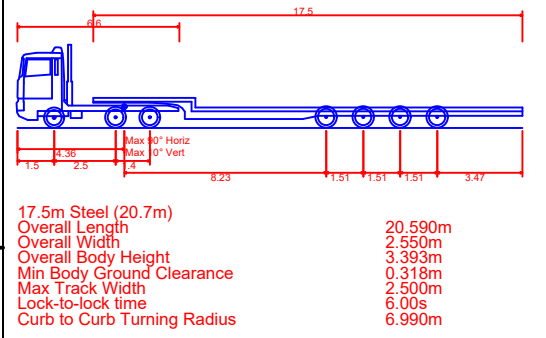

Scale at A3: see inset
 © Crown Copyright. All rights reserved. Licence number AL100001776.

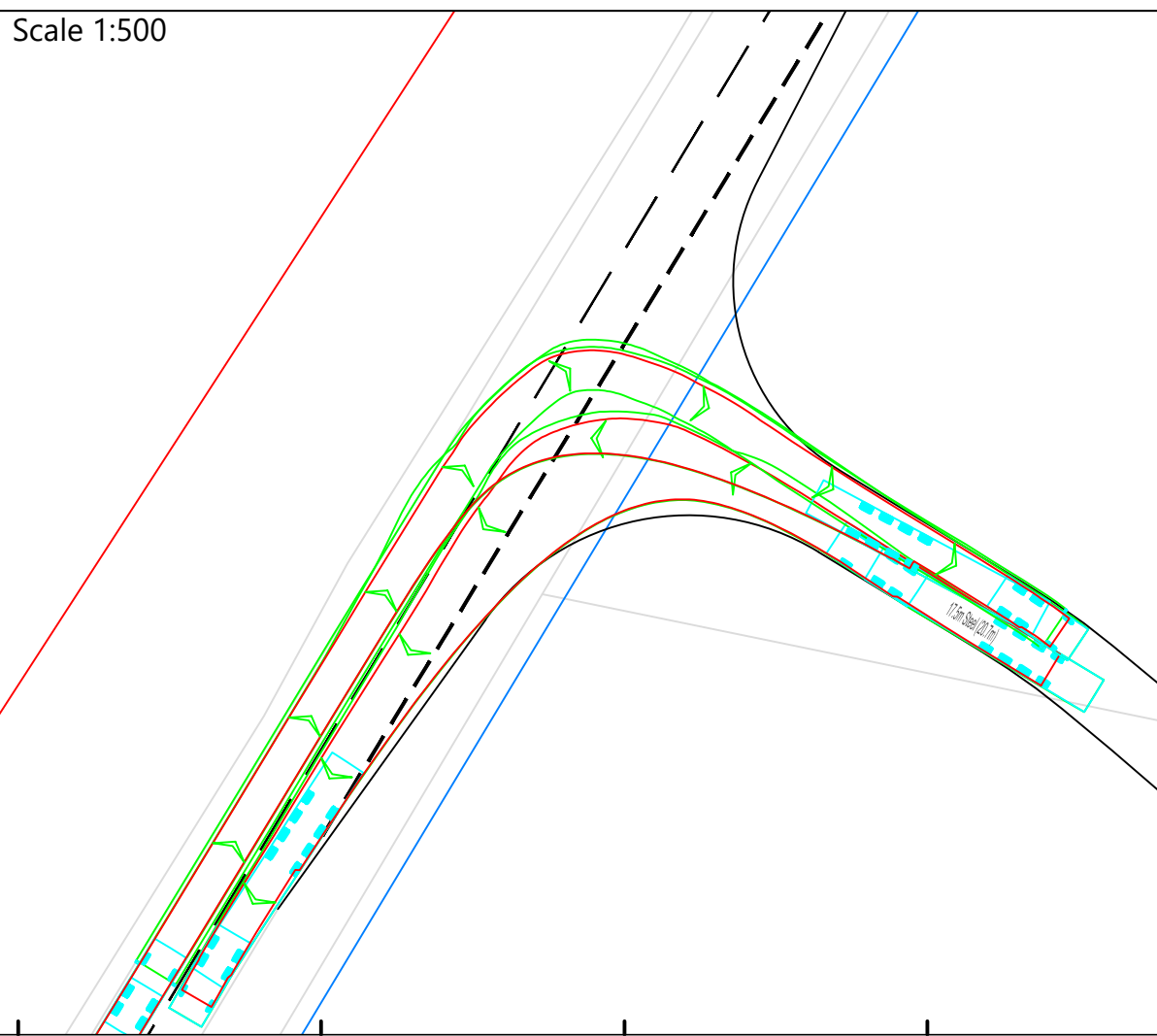
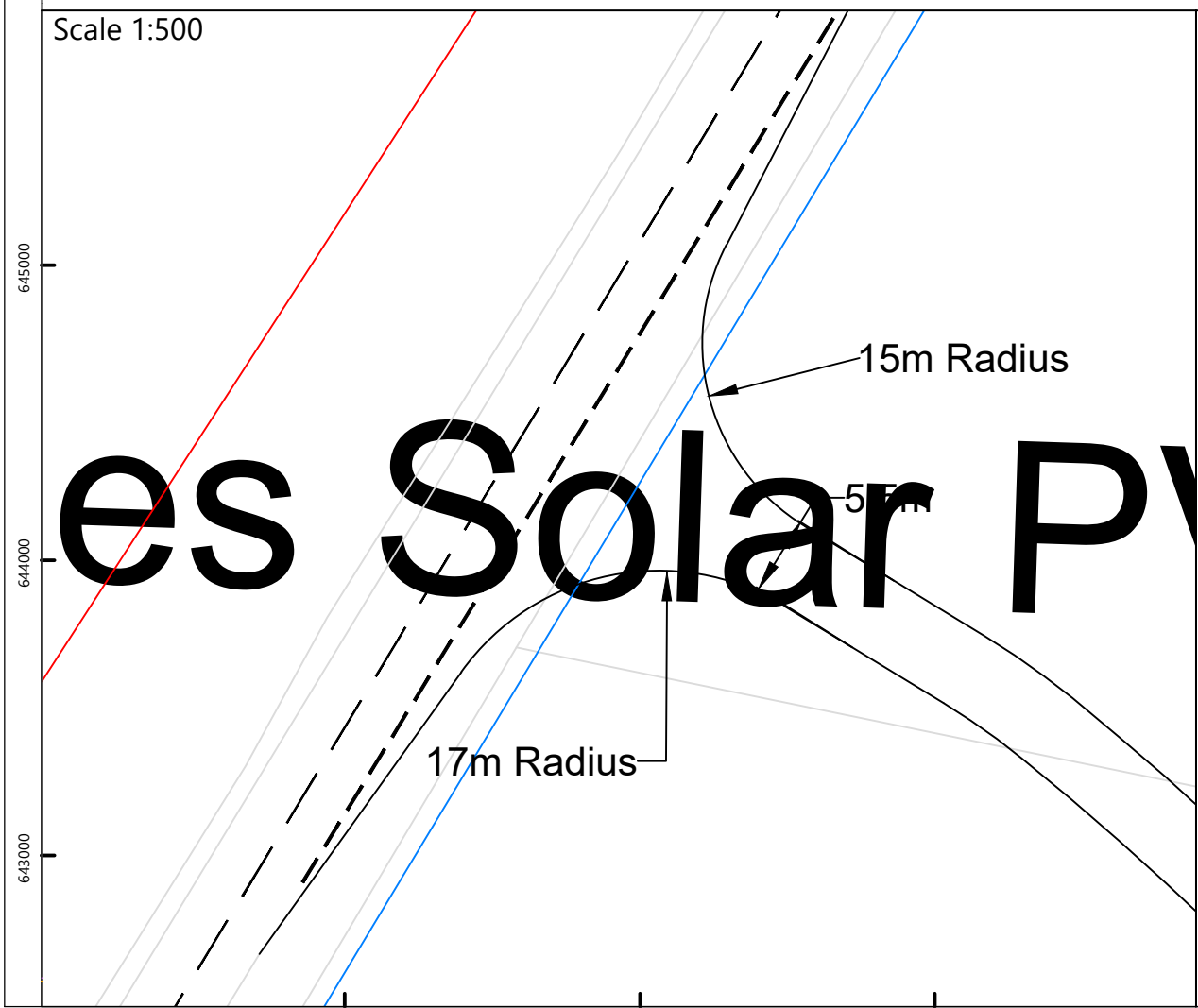

Client

Whitelee Windfarm Extension Solar PV, Green Hydrogen Production and Battery Storage Facilities

Traffic and Transport EIA Chapter
 Figure 9.1 - General Access Arrangement